

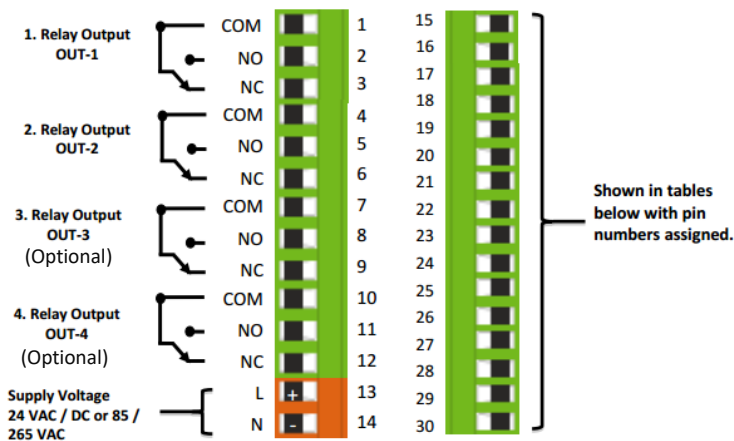

- 4 different analog input functions in one device
- RS-232, RS-485, USB or CANopen communication
- 2 relay outputs (optional 4), adjustable in different functions
- High sampling rate: 3.5 kHz
- Converting analog signals (4-20 mA, 0-20 mA, 0-10 V, potentiometric, ratiometric) to CANopen signals, and CANopen signals to analog.
- Reversible analog output (10-0 V, 20-0mA)
- Fast and multi-parameter configuration via USB
- Compact design
- Easy and user friendly interface
- Tare function
- Menu hiding or password protection

## Connection



Digital Comn.	28	29	30
RS485	A	B	GND
RS232	Rx	Tx	GNDD
USB HID	USB CONNECTOR		
USB VIRTUAL	USB CONNECTOR		
CANopen	CAN HIGH	CAN LOW	GND

## Technical Properties

Display	1st Line(LED Bar): digit height:5mm 2nd Line: 7-segment LED, digit height:14mm
Supply Voltage	24 V <sub>AC/DC</sub> 50/60 Hz 85-265 V <sub>AC</sub> 50/60 Hz
Power usage	9 VA / 2,7 Watt Maksimum
Sensor Supply Voltage	Pot: 5 V <sub>DC</sub> 3,33 mV/V: 10 V <sub>DC</sub> 0-10V: 24 V <sub>DC</sub> 4-20 mA: 24 V <sub>DC</sub> CANopen: 24 V <sub>DC</sub>
Max Sensor Supply Current	100 mA
Refresh Rate	3.5 kHz
Resolution	16 bit
Analogue Inputs	Potentiometer, 0.5-4.5 V, 0-5 V, 0-10 V, 4-20 mA, 0-20 mA, 3,33 mV/V, 2mV/V, 2,5mV/V Ratiometric
Relay Outputs	2 pcs 250 V <sub>AC</sub> 3A (Resistive Load) Relay (optional 4 pcs)
Serial Communication (Optional)	RS-232, RS-485, USB, CANopen
Analogue Outputs (Optional)	0-10 V, 0-5 V, 0.5- 4.5 V, 4-20 mA, 0-20 mA
Electrical Connection	2,5 mm <sup>2</sup> Universal Terminal
Weight	220 gr
Operating Temperature	0 ile 50 °C
Protection Class	IP60 Front Panel, IP20 Back Panel

ANALOG OUTPUTS	20	21	22	23	24*	25*	26*	27*
4-20 mA Output	Signal Output	GND	X	X	Signal Output	GND	Signal Output	GND
0-10 V Output								
0-5 V Output								
0.5-4.5 V Output								
Tare Input	X	X	Tare	GND	X	X	X	X

Physical Interface	Protocol
RS-232, RS-485, VCP	ASCII, ModBus_RTU, ModBus_ASCII
USB	HID DEVICE
CAN	CANopen

SENSOR INPUT	15	16	17	18	19
Potentiometer	1. tip	2. tip	3. tip	X	X
4-20 mA Input 0-20 mA Input 0-10 V Input 0-5 V Input 0.5-4.5 V Input	Supply	Sensor Signal	GND	X	X
mV/V Input	Supply	X	GND	Signal(+)	Signal(-)

## Mechanical Dimensions

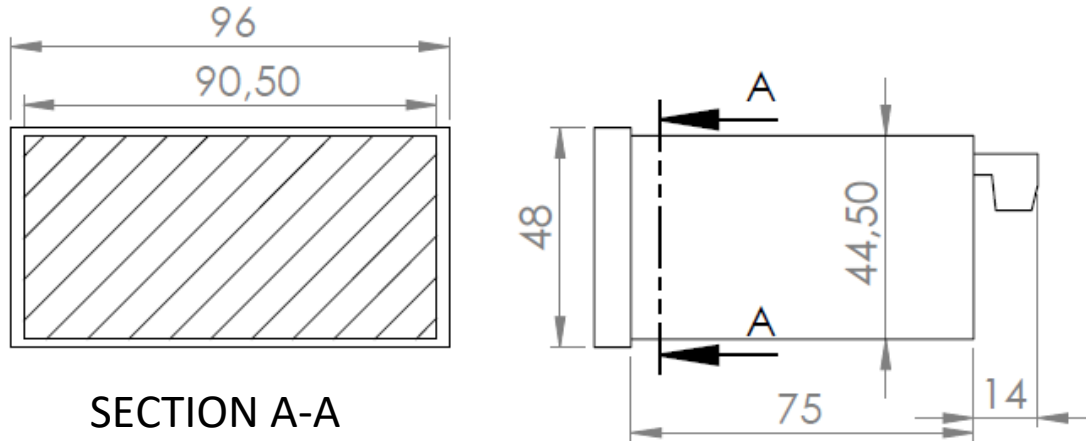

## Order Code

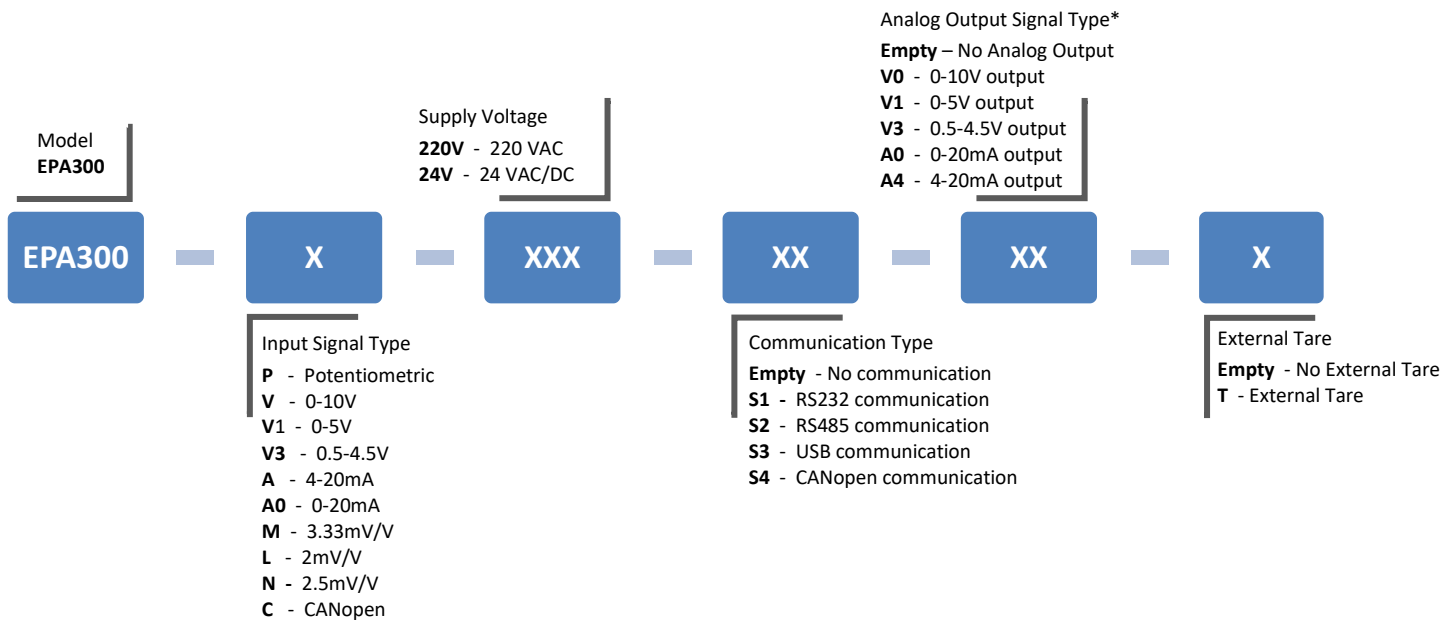

\* Optionally **Dual Analog Output** can be requested. In this case, it is necessary to add "2" code at the beginning of the desired signal output at order coding.

Sample Product Code: EPA300-P-220V-S2-2A4-T

## Eskon Sensor Technology



Gebze OSB, 800. Sokak, No:814 Gebze/KOCAELI/TURKEY  
 Tel: +90 262 673 76 00 Fax: +90 262 673 76 08  
[www.eskonsensor.com](http://www.eskonsensor.com)